

Member IMC Group  
**Ingersoll**  
Cutting Tools



# TaeguTmill

**CHASE MILLING FAMILY**  
**ISO MILLING INSERT**  
**Z-MILL**



**TaeguTec**

# *Chase Milling Family*

Only The Chase Milling Family can satisfy  
all your requirements



 **TaeguTec**  
Member IMC Group



# Index

<i>ChaseMill</i> .....	4 ~ 9
<i>ChaseQuad</i> .....	10 ~ 16
<i>ChaseOcto</i> .....	18 ~ 19
<i>ChaseMold</i> .....	20
<i>ChaseBall</i> .....	21
<i>ISO Milling Insert</i> .....	22 ~ 23
<i>Z-Mill</i> .....	24 ~ 26
<i>Technical Information</i> .....	27 ~ 35



# ChaseMill

## Features

- Helical higher positive cutting edges guarantee smooth, quiet and efficient cutting with greater accuracy.
- TE90AX 90 degree end mills and TFM90AX face mills using **AXMT 0903 PER-EML** or **AXMT 0903 PER-AL** insert, are designed for less-rigid machines and setups where maximum insert density and depth of cuts under .350 provide optimum productivity.
- TE90AP 90 degree end mills & TFM90AP face mills using **APKT 1705 PER-M** or **EL** or **EM** or **AL** inserts, provide superior strength, versatility and accuracy when milling all materials up to .635" depth of cut.
- Corner radius and regular **-EL** or **-EM** or **-EML** inserts, which provide a variety of accurate cutting radii with pressed wiper flat provide economical and superior performance.
- New **AXMT 0903 PER-EML** & **AXMT 090308R-EML** inserts with improved cutting performance are mounted on new TE90AX & TFM90AX cutters and the same TE90AD & TFM90AD cutters.
- For Face milling, Slotting, Shoulder milling, Contouring, Straight and Helical Ramping.



## Applications

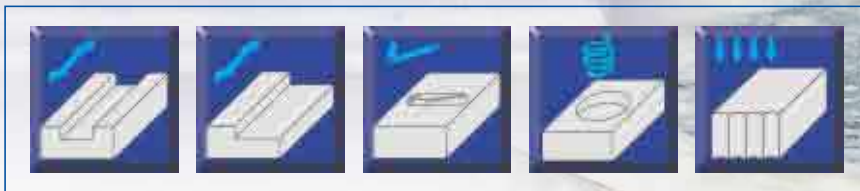

## REGULAR INSERT

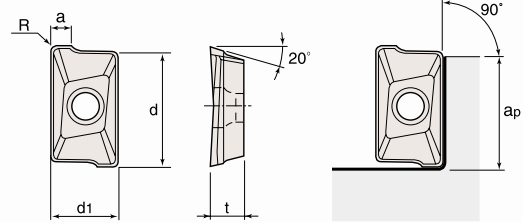
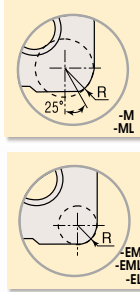

Designation	Dimension (inch)						Coated					Uncoated	
	d	d <sub>1</sub>	a	t	R	ap	TT9030	TT8030	TT8020	TT7030	TT6030	P30	K10
AXMT 0903 PER-EML	.374	.244	.049	.142	.020	.350	○	○	○	○	○		○
AXMT 0903 PER-ML	.374	.244	.049	.142	.020	.350			○	○	○		
APKT 1705 PER-M	.670	.421	.129	.219	.031	.635			○	○	○		○
APKT 1705 PER-EM	.670	.421	.129	.219	.031	.635	○	○	○	○	○	○	○
<b>NEW</b> APKT 1705 PER-EL	.670	.421	.114	.219	.031	.635	○		○				

## CORNER RADIUS INSERT

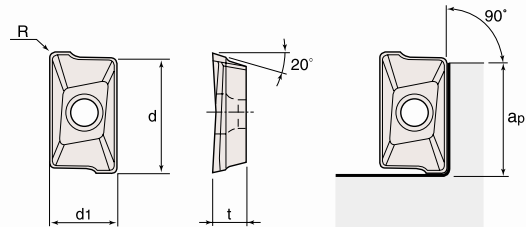
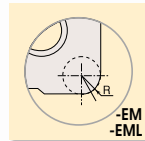
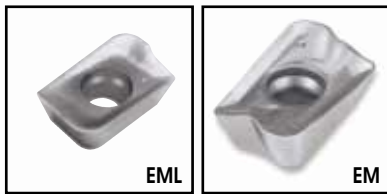

Designation	Dimension (inch)						Coated					Uncoated
	d	d <sub>1</sub>	t	R	ap	TT9030	TT8030	TT8020	TT7030	TT6030	P30	
AXMT 090308R-EML	.374	.244	.142	.031	.350	○	○	○	○	○		
<b>NEW</b> AXMT 090316R-EML	.374	.244	.142	.062	.350	○		○	○	○		
<b>NEW</b> APKT 170504R-EM	.671	.421	.219	.015	.635			○	○	○		
APKT 170516R-EM	.670	.421	.219	.062	.635	○		○	○	○		
APKT 170524R-EM	.670	.421	.219	.093	.635			○	○	○	○	
APKT 170532R-EM	.670	.421	.219	.125	.635	○		○	○	○	○	
APKT 170548R-EM	.670	.421	.219	.187	.635			○	○	○	○	
APKT 170564R-EM	.670	.421	.219	.250	.635			○	○	○	○	
<b>NEW</b> APKT 1705□□R-M	.671	.421	.219	.015-.250	.635			○				

• □□ = 04~64 : Various tailor-made corner radius (.015~.250)

## INSERTS FOR ALUMINUM MACHINING

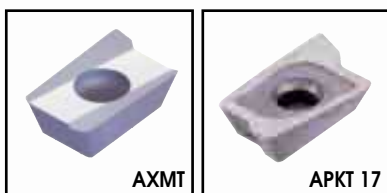

Designation	Dimension (inch)					Uncoated
	d	d <sub>1</sub>	t	R	ap	K10
AXMT 0903 PER-AL	.374	.244	.134	.020	.350	○
APKT 1705 PER-AL	.670	.421	.211	.031	.635	○

# ChaseMill

## End Mill



TE90AP- □□□

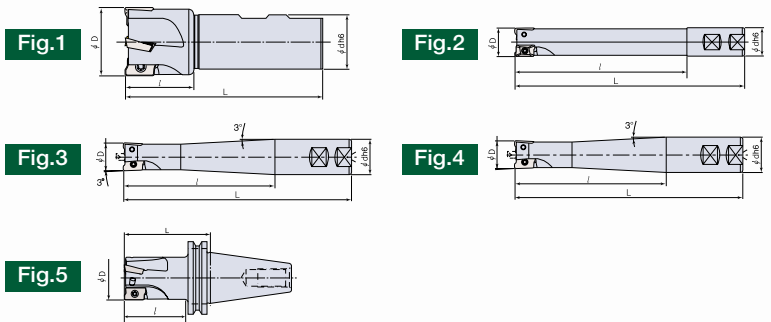

### Standard length End Mills

Designation	Insert	⊕	Dimension (inch)				Fig.	Screw	Wrench
			D	d	L	l			
TE90AP-D.75-W.75-17	APKT 1705 PER-M APKT 1705 PER-EM <b>NEW</b> APKT 1705 PER-EL APKT 1705 □□ R-EM APKT 1705 PER-AL	1	.75	.75	3.75	1.25	1	TS40080I	TD15
TE90AP-D1.00-W1.00-17		2	1.00	1.00	4.00	1.50	1		
TE90AP-D1.25-W1.25-17		3	1.25	1.25	4.50	1.60	1	TS40093I	
TE90AP-D1.50-W1.25-17		4	1.50	1.25	4.50	1.60	1		
TE90AP-D1.50-W1.25-17-B		3	1.50	1.25	4.50	1.60	1		
TE90AP-D1.75-W1.25-17		4	1.75	1.25	4.50	1.70	1		
TE90AP-D2.00-W1.25-17		5	2.00	1.25	4.50	1.70	1	1	
TE90AP-D1.00-CAT40-17		2	1.00	—	2.50	1.55	5	TS40080I	
TE90AP-D1.25-CAT40-17		3	1.25	—	2.87	1.92	5	TS40093I	
TE90AP-D1.50-CAT40-17		3	1.50	—	2.87	1.92	5		

### Long type End Mills

Designation	Insert	⊕	Dimension (inch)				Fig.	Screw	Wrench
			D	d	L	l			
TE90AP-D1.00-W1.00-17-L	APKT 1705 PER-M APKT 1705 PER-EM <b>NEW</b> APKT 1705 PER-EL APKT 1705 □□ R-EM APKT 1705 PER-AL	2	1.00	1.00	6.00	3.75	1	TS40080I	TD15
TE90AP-D1.00-W1.00-17-XL1		2	1.00	1.00	8.00	6.00	2		
TE90AP-D1.00-W1.00-17-XL2		2	1.00	1.00	10.00	8.00	2		
TE90AP-D1.00-W1.25-17-XL1		2	1.00	1.25	8.00	5.75	3		
TE90AP-D1.00-W1.25-17-XL2		2	1.00	1.25	10.00	7.75	3		
TE90AP-D1.00-W1.25-17-XL3		2	1.00	1.25	8.00	5.00	4	TS40093I	
TE90AP-D1.00-W1.25-17-XL4		2	1.00	1.25	10.00	7.00	4		
TE90AP-D1.25-W1.25-17-L		3	1.25	1.25	6.50	4.25	1		
TE90AP-D1.25-W1.25-17-XL1		3	1.25	1.25	8.00	5.25	2		
TE90AP-D1.25-W1.25-17-XL2		3	1.25	1.25	10.00	7.25	2		
TE90AP-D1.50-W1.25-17-L		3	1.50	1.25	6.50	1.80	1		
TE90AP-D1.50-W1.25-17-XL1		3	1.50	1.25	8.00	1.80	1		
TE90AP-D1.50-W1.50-17-XL1		3	1.50	1.50	8.00	5.50	2		
TE90AP-D1.50-W1.50-17-XL2		3	1.50	1.50	10.00	7.50	2		
TE90AP-D1.50-W1.50-17-XL3		3	1.50	1.50	11.00	8.50	2		

- L type : Long Shank
- XL1, XL2 type : Extra Long Shank
- B type : Coarse pitch End Mill
- Extended Reach End Mills are not as rigid as standard length End Mills.  
Reduce DOC(Depth of Cut) and FPT(Feed per Tooth) to reduce risk of chatter.

## End Mill New



TE90AX- □□□

Fig.1

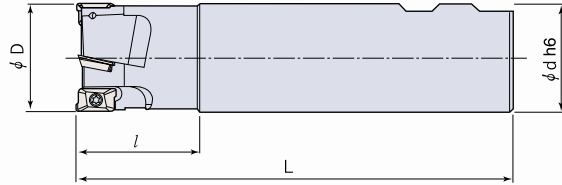

Fig.2



Designation	Insert		Dimension (inch)				Fig.	Screw	Wrench
			D	d	L	l			
TE90AX-D.38-W.50-09	AXMT 0903 PER-EML AXMT 0903 PER-ML AXMT 090308R-EML AXMT 090316R-EML AXMT 0903 PER-AL	1	.375	.500	3.00	.79	1	TS25055I/HG	TD8
TE90AX-D.44-W.62-09		1	.437	.625	3.25	1.03	1		
TE90AX-D.50-W.62-09		1	.500	.625	3.25	1.03	1		
TE90AX-D.56-W.62-09		1	.560	.625	3.25	1.03	1		
TE90AX-D.62-W.62-09		2	.625	.625	3.25	1.18	1		
TE90AX-D.70-W.75-09		2	.700	.750	3.35	1.18	1		
TE90AX-D.75-W.75-09		2	.750	.750	3.75	1.18	1		
TE90AX-D.75-W.75-09-J		3	.750	.750	3.75	1.18	1		
TE90AX-D.75-W.75-09-L		2	.750	.750	4.75	2.75	1		
TE90AX-D.75-W.75-09-XL <span style="color: red; border: 1px solid red; border-radius: 50%; padding: 2px;">NEW</span>		2	.750	.750	6.00	2.75	2		
TE90AX-D.75-W.75-09-XL I		2	.750	.750	8.00	6.00	2		
TE90AX-D.88-W.75-09		3	.875	.750	3.75	1.18	1		
TE90AX-D1.00-W.75-09		3	1.000	.750	3.75	1.18	1		
TE90AX-D1.00-W.75-09-J		4	1.000	.750	3.75	1.18	1		
TE90AX-D1.00-W1.00-09-L		2	1.000	1.000	6.00	1.50	1		
TE90AX-D1.12-W1.00-09		3	1.125	1.000	3.75	1.18	1		
TE90AX-D1.25-W1.00-09		4	1.250	1.000	3.75	1.20	1		
TE90AX-D1.50-W1.00-09		4	1.500	1.000	4.00	1.25	1		
TE90AX-D2.00-W1.00-09		5	2.000	1.000	4.00	1.25	1		

- L type : Long Shank
- XL & XLI type : Extra Long Shank
- J type : Cross pitch End Mill
- Extended Reach End Mills are not as rigid as standard length End Mills.  
Reduce DOC(Depth of Cut) and FPT(Feed per Tooth) to reduce risk of chatter.
- TE90AX end mills are supplied when the stock of TE90AD end mill is depleted.

TaeguTmill - Chase Milling Family

# ChaseMill



## Coolant through End Mill

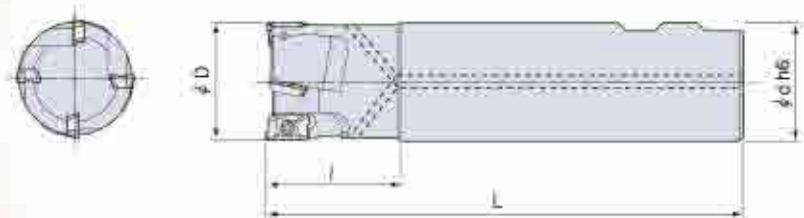

Designation	Insert		Dimension (inch)				Fig.	Screw	Wrench
			D	d	L	l			
TE90AP-D1.00-W1.00-17-C	APKT 1705 PER-M	2	1.00	1.00	4.00	1.50	1	TS40080I	TD15
TE90AP-D1.25-W1.25-17-C	APKT 1705 PER-EM	3	1.25	1.25	4.50	1.60	1	TS40093I	
TE90AP-D1.50-W1.25-17-C	APKT 1705 PER-EL	4	1.50	1.25	4.50	1.60	1		
TE90AP-D1.50-W1.25-17-BC	APKT 1705 □ R-EM APKT 1705 PER-AL	3	1.50	1.25	4.50	1.60	1		
TE90AX-D.75-W.75-09-C	AXMT 0903 PER-EML	2	.750	.750	3.75	1.18	1	TS25055I/HG	TD8
TE90AX-D1.00-W.75-09-C	AXMT 0903 PER-ML AXMT 090308R-EML AXMT 090316R-EML AXMT 0903 PER-AL	3	1.000	.750	3.75	1.18	1		

- C type : Coolant through End Mill
- TE90AX end mills are supplied when the stock of TE90AD end mill is depleted.

## Extended Flute End Mill

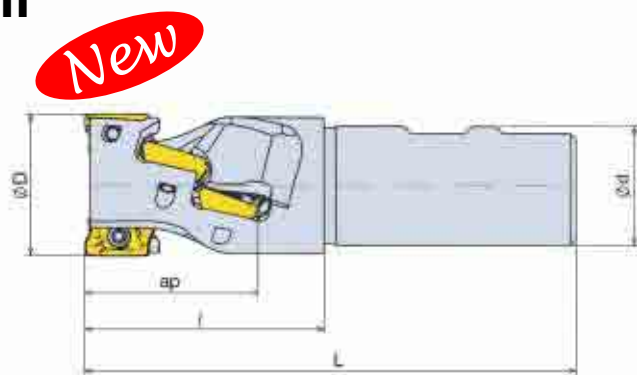

Designation	Insert		No. of Inserts	Dimension (inch)					Screw	Wrench
				D	L	l	ap	d		
TEF-D1.25-W1.25-AP17	APKT 1705 PER-EM APKT 1705 PER-M	2	4	1.25	4.75	1.96	1.18	1.25	TS40093I	TD15
TEF-D1.50-W1.25-AP17	APKT 170504 R-EM APKT 1705 PER-EL APKT 1705 PER-AL	2	6	1.50	5.50	2.55	1.74	1.25		

## Face Mill



TFM90AX-□□

**New**

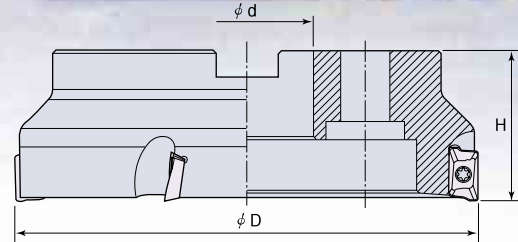

Fig1



TFM90AP-□□

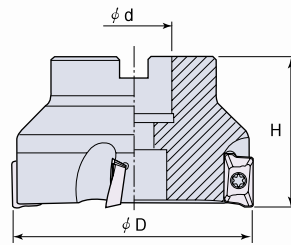

Fig.2

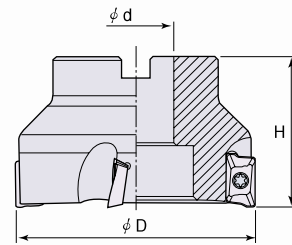

Fig.3

Designation	Insert		Dimension (inch)			Weight (lb)	Fig.	Screw	Wrench
			D	d	H				
TFM90AP -D2.00R-17-B	APKT 1705 PER-M APKT 1705 PER-EM APKT 1705 □□ R-EM APKT 1705 PER-AL <b>NEW</b> APKT 1705 PER-EL	3	2.00	.75	1.57	.88	1	TS40120I	T-T15
TFM90AP -D2.00R-17		5	2.00	.75	1.57	.88	1		
TFM90AP -D2.50R-17		6	2.50	.75	1.57	1.1	1		
TFM90AP -D3.00R-17-B		4	3.00	1.00	1.75	1.8	2		
TFM90AP -D3.00R-17		7	3.00	1.00	1.75	1.7	2		
TFM90AP -D4.00R-17-B		6	4.00	1.50	2.00	2.8	2		
TFM90AP -D4.00R-17		8	4.00	1.50	2.00	2.6	2		
TFM90AP -D5.00R-17		9	5.00	1.50	2.00	6.8	2		
TFM90AP -D6.00R-17-B		8	6.00	2.00	2.00	11.0	2		
TFM90AP -D6.00R-17		10	6.00	2.00	2.00	11.0	2		
TFM90AP -D8.00R-17		12	8.00	2.50	2.37	14.7	3		
TFM90AX-D1.50R-09		AXMT 0903 PER-EML AXMT 0903 PER-ML AXMT 090308R-EML <b>NEW</b> AXMT 090316R-EML AXMT 0903 PER-AL	5	1.50	.75	1.57	.7		
TFM90AX-D2.00R-09	6		2.00	.75	1.57	.9	1		
TFM90AX-D2.50R-09	8		2.50	.75	1.57	1.1	1		
TFM90AX-D3.00R-09	10		3.00	1.00	1.75	1.8	1		

• TFM90AX face mills are supplied when the stock of TFM90AD cutter is depleted.

# ChaseQuad

## ChaseQuad for Drill-Mill, Plunging & Extended flute end mill

### Features

- Variety of tools for Counter Boring, Spot Facing, Drill Milling, Plunge Milling, End Milling and Extended Flute End Mills cover needs for Die & Mold Industry.
- Just 4 sizes of inserts cover full range of operating conditions.
- SPMG inserts with chipbreaker and sharp cutting edges are for drilling.
- SPMT inserts with rake face geometry and strong cutting edges are best for roughing and general applications.

### Mounting Instruction of XOMT Insert

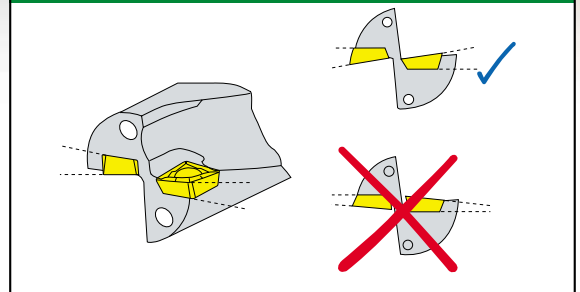

## Insert



**XOMT 060204**

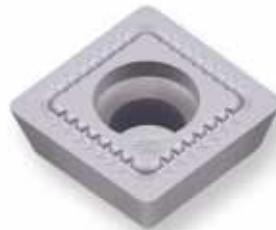

**SPMG 090408-EM  
SPMG 110408-EM  
SPMG 140508-EM**



**SPMT090408-EM  
SPMT110408-EM  
SPMT140508-EM**

Designation	Coated		
	TT8020	TT7030	TT6030
XOMT060204	○	○	○
SPMG 090408-EM, SPMT 090408-EM	○	○	○
SPMG 110408-EM, SPMT 110408-EM	○	○	○
SPMG 140508-EM, SPMT 140508-EM	○	○	○

## End mill for Counter Boring, Spot Facing & Plunging

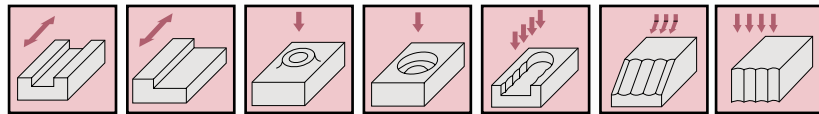
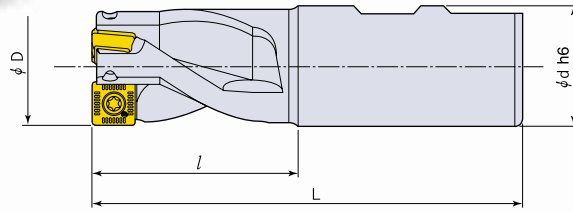

Designation	Insert		Dimension (inch)					Max. C'bore depth, Cd	ap
			D	l	d	L			
TSF-D.44-W.75-06	XOMT 060204	1	.438	.80	.750	3.20	.50	.220	
TSF-D.53-W.75-06		1	.531	1.10	.750	3.50	.70		
TSF-D.62-W.75-06		2	.625	1.10	.750	3.50	.70		
TSF-D.71-W.75-06		2	.710	1.30	.750	3.70	1.00		
TSF-D.75-W.75-06		3	.750	1.30	.750	3.70	1.00		
TSF-D.81-W.75-06		3	.813	1.50	.750	4.00	1.20		
TSF-D.87-W.75-09	SPMG 090408-EM SPMT 090408-EM	2	.875	1.50	.750	4.00	1.20	.355	
TSF-D1.00-W1.00-09		2	1.000	1.90	1.00	4.30	1.50		
TSF-D1.18-W1.25-09		3	1.187	2.00	1.25	4.50	1.55		
TSF-D1.25-W1.25-11	SPMG 110408-EM SPMT 110408-EM	3	1.250	2.00	1.25	4.50	1.55	.422	
TSF-D1.37-W1.25-11		3	1.375	2.00	1.25	4.50	1.55		
TSF-D1.50-W1.25-11		3	1.500	2.40	1.25	4.90	1.80		
TSF-D1.63-W1.25-11		4	1.625	2.40	1.25	4.90	1.80		
TSF-D1.75-W1.25-14	SPMG 140508-EM SPMT 140508-EM	3	1.750	2.60	1.25	5.10	2.00	.528	
TSF-D2.00-W1.25-14		4	2.000	3.00	1.25	5.90	2.40		

### COMPONENTS

Size	Insert	Screw	Wrench	
TSF-D.44~D.53	XOMT 060204	TS22046I	TD7	
TSF-D.62~D.81	XOMT 060204	TS22052I/HG	TD7	
TSF-D.87~D1.18	SPMG/T 090408-EM	TS35088I	TD10	
TSF-D1.25~D1.63	SPMG/T 110408-EM	TS40093I	TD15	
TSF-D1.75~D2.00	SPMG/T 140508-EM	SO50090I	TD20	

# ChaseQuad

## D Drill-Mill

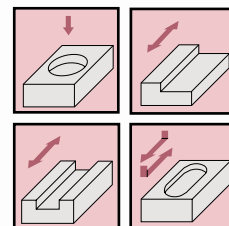
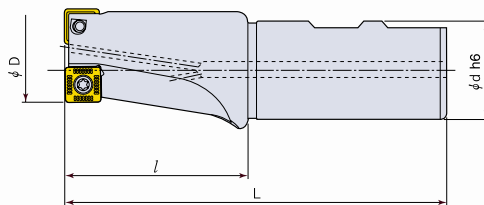

Designation	Insert		Dimension (inch)						Screw	Wrench
			D	l	d	L	Max. Drilling depth, Cd	ap		
TDM -D.50-W.75-06	XOMT 060204	1	.500	.80	.750	3.20	.50	.220	TS22046I	TD7
TDM -D.62-W.75-06		2	.625	1.10	.750	3.50	.80			
TDM -D.71-W.75-06		2	.719	1.30	.750	4.00	.90			
TDM -D.75-W.75-06		2	.750	1.30	.750	4.00	.90			
TDM -D.81-W1.00-06		2	.813	1.50	1.00	4.00	1.00			
TDM -D.84-W1.00-06		2	.844	1.50	1.00	4.00	1.00			
TDM -D1.00-W1.00-09	SPMG 090408-EM, SPMT 090408-EM	2	1.000	1.60	1.00	4.00	1.20	.355	TS35088I	TD10
TDM -D1.18-W1.25-11	SPMG 110408-EM SPMT 110408-EM	2	1.187	2.10	1.25	4.50	1.55	.422	TS40093I	TD15
TDM -D1.25-W1.25-11		2	1.250	2.10	1.25	4.50	1.55			
TDM -D1.37-W1.25-11		2	1.375	2.10	1.25	4.50	1.55			
TDM -D1.50-W1.25-11		2	1.500	2.40	1.25	4.90	1.85			
TDM -D1.75-W1.25-14	SPMG 140508-EM	2	1.750	2.60	1.25	5.10	2.05	.528	SO50090I	TD20
TDM -D2.00-W1.25-14	SPMT 140508-EM	2	2.000	2.80	1.25	5.60	2.20			

## E nd mill for Chamfering

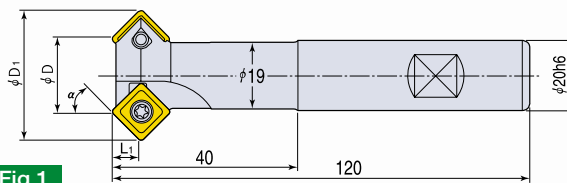

Fig.1

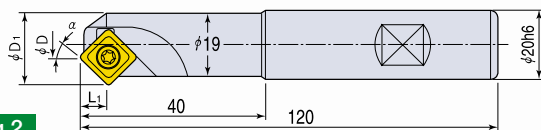
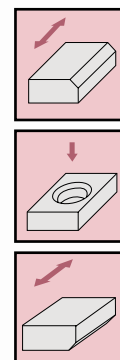

Fig.2



Designation	Insert	No. of Teeth	Dimension (inch)				Fig.	Application Range	Screw	Wrench
			$\alpha$	D	D <sub>1</sub>	L <sub>1</sub>				
TCF15-D1.0-11	SPMT 110408-EM	2	15°	1	1.22	.4	2	Ø1.05 ~ Ø1.15	TS40093I	TD15
TCF30-D1.0-11		2	30°	1	1.42	.35	1	Ø1.05 ~ Ø1.35		
TCF45-D.30-11		1	45°	.3	.89	.28	2	Ø.35 ~ Ø.85		
TCF45-D.75-11		2	45°	.75	1.34	.28	1	Ø.80 ~ Ø1.30		
TCF45-D1.25-11		3	45°	1.25	1.84	.28	1	Ø1.30 ~ Ø1.80		

## Extended Flute End Mill

Full Effective

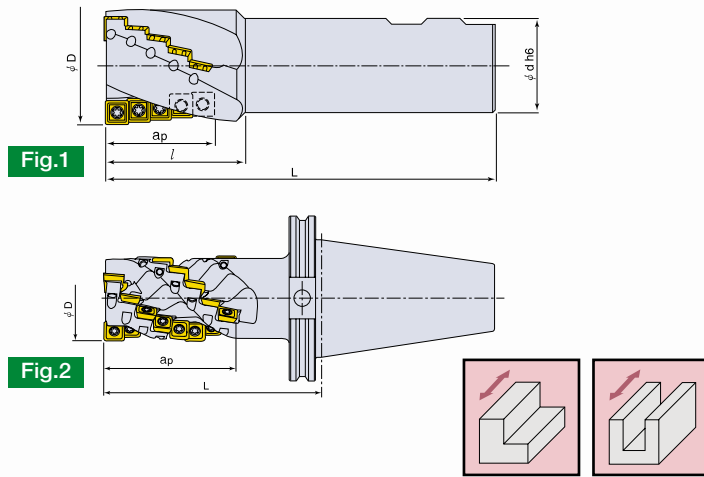

Designation	Insert	Flute	No. of Inserts	Dimension (inch)					Fig.	Screw	Wrench
				D	ap	d	l	L			
TEF-D1.25-W1.25-09	SPMT 090408-EM	2	10	1.25	1.53	1.25	2.10	4.75	1	TS35088I	TD10
TEF-D1.50-W1.25-11B	SPMT 110408-EM	2	12	1.50	2.28	1.25	3.08	5.50	1	TS40093I	TD15
TEF-D1.50-W1.25-11		3	18	1.50	2.28	1.25	3.08	5.50	1		
TEF-D2.00-W1.25-11		3	18	2.00	2.28	1.25	3.08	5.50	1		
TEF-D2.00-CAT50-11		3	24	2.00	3.02	-	-	5.00	2		

## Extended Flute Shell Mill

Full Effective

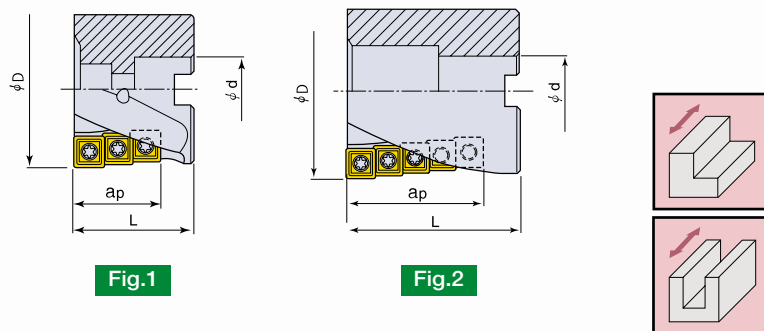

Designation	Insert	Flute	No. of Insert	Dimension (inch)				Fig.	Screw	Wrench
				D	ap	d	L			
TES-D2.00-1.0-.75-11	SPMT 110408-EM	3	9	2.00	1.16	.75	2.05	1	TS40093I	TD15
TES-D2.50-1.8-1.00-14	SPMT 140508-EM	3	15	2.50	2.40	1.00	3.00	1	SO50090I	T-T20
TES-D3.00-2.4-1.25-14		3	15	3.00	2.40	1.25	3.20	1		
TES-D3.00-2.9-1.25-14		4	24	3.00	2.88	1.25	3.60	1		
TES-D4.00-2.9-1.50-14		4	24	4.00	2.90	1.50	3.60	2		

# ChaseQuad

## ChaseQuad for General Milling

### Features

- General purpose face mills for high productivity
- Special rake face geometry of SEKT 12T3 insert provides longer tool life due to fast heat evacuated in chip
- Added insert shim seat provides protection for longer cutter body life
- New wiper insert SEKT 12T3 AFTR-WC for finishing

### Insert



SEKT 12T3 AFTN-M



SEKT 12T3 AFTR-WC

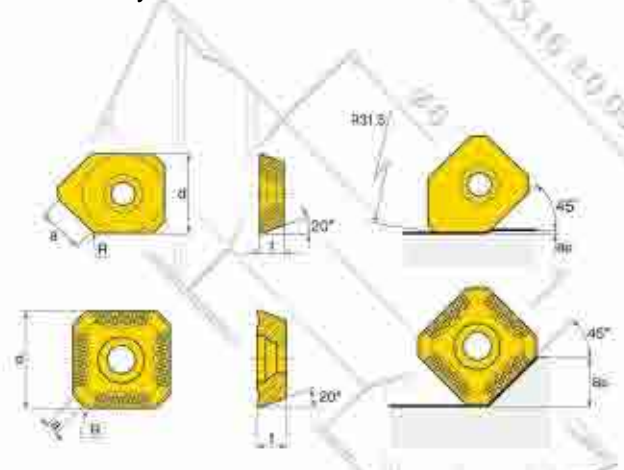

Designation	Dimension (inch)					Coated				Uncoated	Cermet
	d	t	a	R	ap	TT9030	TT8020	TT7030	TT6030	P30	CT520
SEKT 12T3 AFTN-M	.520	.150	.100	.043	.266	○	○	○	○	○	○
SEKT 12T3 AFTR-WC	.520	.150	.291	.047	.040		○	○	○		

● WC : Wiper Insert

### End Mill

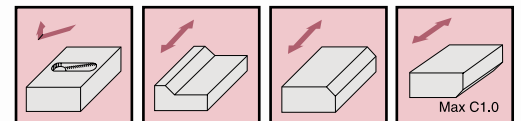
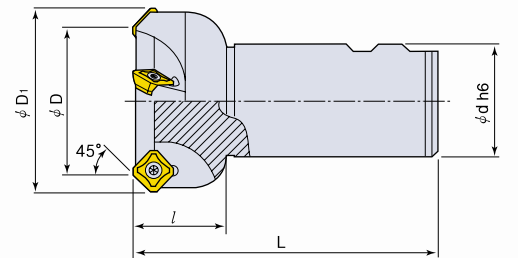

Designation	Insert	⊕	Dimension (inch)						Screw	Wrench
			D	D1	D2	d	L	l		
TE45SE - D1.00-W1.00-12	SEKT 12T3 AFTN-M	2	1.00	1.47	1.38	1.00	3.50	1.09	TS35110I-L8.5	TD15
D1.25-W1.25-12		3	1.25	1.72	1.60	1.25	4.00	1.25		
D1.50-W1.25-12		4	1.50	1.97	1.84	1.25	4.00	1.25		
D2.00-W1.25-12		5	2.00	2.47	2.32	1.25	4.00	1.25		

## Face Mill

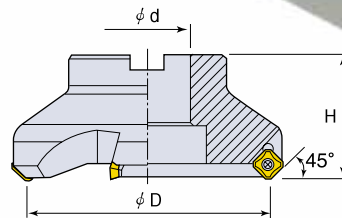

Fig.1

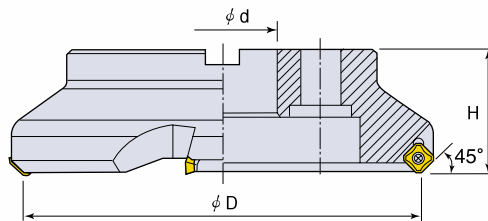

Fig.2

Designation	Insert		Dimension (inch)			Weight (lb)	Fig.	Mounting Ref.	
			D	d	H				
TFM45SE -D2.00R-12	SEKT 12T3 AFTR-WC SEKT 12T3 AFTN-M		4	2.00	.75	1.75	1.0	1	B
-D2.50R-12			5	2.50	.75	1.75	1.1	1	B
-D3.00R-12			5	3.00	1.00	1.75	2.0	1	B
-D4.00R-12			6	4.00	1.50	2.00	3.1	1	B
-D5.00R-12			7	5.00	1.50	2.00	5.2	1	B
-D6.00R-12			8	6.00	2.00	2.00	11.0	1	B
-D8.00R-12			10	8.00	2.50	2.50	14.7	2	C
-D10.00R-12			13	10.00	2.50	2.50	18.7	2	C

### COMPONENTS

	Seat	Seat Screw	Screw	Wrench
	TSE-12T3-N	TS5035062S	TS35110I	T-T15

# ChaseQuad

## Face Mill



**New**

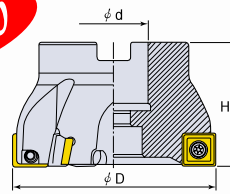

Fig.1

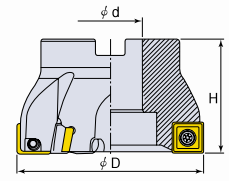

Fig.2

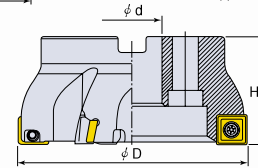
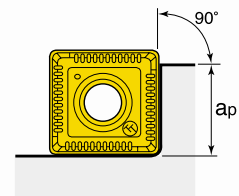
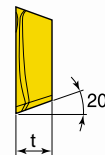
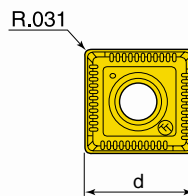

Fig.3

Designation	Insert		Dimension (inch)			Weight (lb)	Fig.
			D	H	d		
TFM90SE-D2.00R -13	SEMT 1304 PETR-M	5	2.00	1.57	.75	.9	1
TFM90SE-D2.00R -13-M		4	2.00	1.57	.75	.9	1
TFM90SE-D2.00R-13-B		3	2.00	1.57	.75	1.0	1
TFM90SE-D2.50R -13		5	2.50	1.57	.75	1.2	1
TFM90SE-D3.00R -13		6	3.00	1.75	1.00	2.0	2
TFM90SE-D3.00R-13-B		4	3.00	1.75	1.00	2.3	2
TFM90SE-D4.00R -13		7	4.00	2.00	1.50	3.0	2
TFM90SE-D4.00R-13-B		5	4.00	2.00	1.50	3.8	2
TFM90SE-D5.00R -13		8	5.00	2.00	1.50	6.5	2
TFM90SE-D6.00R-13		12	6.00	2.00	2.00	10.0	3
TFM90SE-D6.00R-13-B		8	6.00	2.00	2.00	10.3	3

Designation	Insert		Dimension (mm)			Weight (lb)	Fig.
			D	H	d		
TFM90SE-450-22R-13	SEMT 1304 PETR-M	4	50	40	22	.4	1
TFM90SE-563-22R-13		5	63	40	22	.6	1
TFM90SE-680-27R-13		6	80	50	27	1.2	2
TFM90SE-7100-32R-13		7	100	50	32	1.6	2
TFM90SE-8125-40R-13		8	125	63	40	2.9	2
TFM90SE-12160-40R-13		12	160	63	40	5.1	3

## Insert



Designation	Dimension (inch)			NEW	Coating				Uncoated	CERMET
	d	t	ap		TT9030	TT8020	TT7030	TT6030	P30	CT520
SEMT 1304 PETR-M	.539	.187	.433	○	○	○	○	○	○	○

### COMPONENTS

	Seat	Seat Screw	Screw	Wrench
	TSD-12T3-N	TS6040093S	TS401201	T-T15

\* Not used for TFM90SE - D2.00R-13



# *Chase Milling Family*

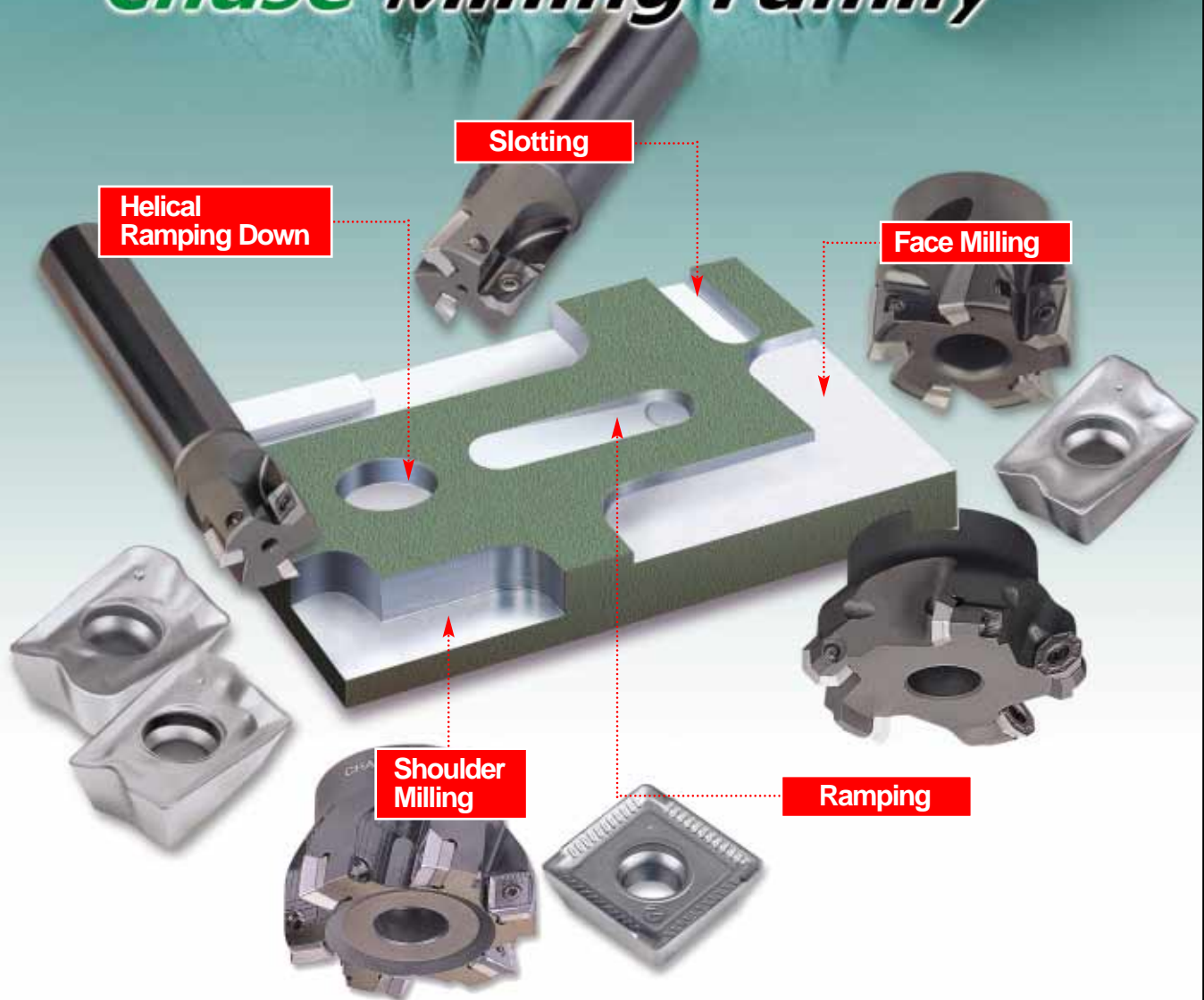

# ChaseOcto

## Features

- ChaseOcto insert ensures efficient cutting of all 8 cutting edges
- Four types of inserts cover all operating conditions (EMR & MR, EM & M, EML & ML and Round)
- High positive insert ensures less vibration and less power consumption
- Round inserts for Die & Mold industry fit the ChaseOcto cutter
- Super high positive inserts for aluminum

## Insert

■ OFCW □□, OFCT □□, OFMT □□ & RFMT □□



Designation	Coated				Uncoated		CERMET
	TT9030	TT8020	TT7030	TT6030	P30	K10	CT520
OFCW 05T3 TN-MR		○	○	○	○	○	
OFCW 05T3 TN-EMR		○	○	○			○
OFCT 05T3 TN-M		○	○	○	○		
OFCT 05T3 TN-EM	○	○	○	○			
<b>NEW</b> OFCT 05T3 TN-AL						○	
OFMT 05T3 TN-ML	○	○	○	○		○	
RFMT 1404 ML		○	○	○			

■ OFCN □□, OFMR □□, OFCR □□ & RFMR □□

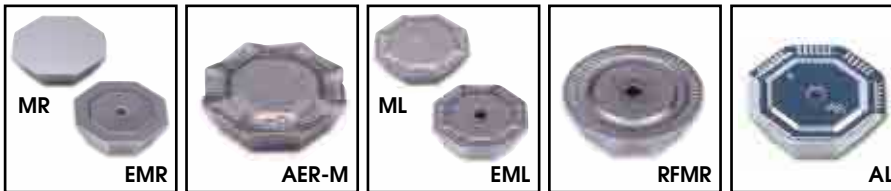

Designation	Coated				Uncoated	
	TT9030	TT8020	TT7030	TT6030	P30	K10
OFCN 0704 TN-MR		○	○	○		○
OFCN 0704 TN-EMR		○	○	○		
OFMR 0704 AER-M	○	○	○	○		
OFCR 0704 TN-ML		○	○	○	○	○
OFCR 0704 TN-EML	○	○	○	○		
RFMR 1904 M	○	○	○	○		
OFMR 0704 TN-AL						○

## Insert

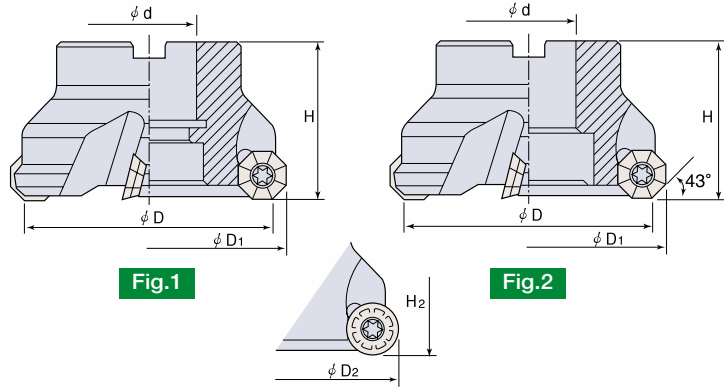

Designation		Dimension (inch)						Weight (lb)	Fig	Mounting Bolt	Screw	Wrench
		D	D <sub>1</sub>	D <sub>2</sub>	d	H	H <sub>2</sub>					
TFM43OFS -D2.00R-05	5	2.00	2.29	2.34	.75	1.57	1.59	1.3	1	SH-3-8I	TS40093I	T-T15
-D2.50R-05	6	2.50	2.79	2.84	.75	1.57	1.59	2.2	1	SH-3-8I		
-D3.00R-05	7	3.00	3.29	3.34	1.00	1.75	1.77	2.9	2	-		
-D4.00R-05	8	4.00	4.29	4.34	1.50	2.00	2.02	5.7	2	-		
-D5.00R-05	9	5.00	5.29	5.34	1.50	2.00	2.02	6.6	2	-		

■ D<sub>2</sub> & H<sub>2</sub> : Dimensions with Round inserts RFMT14

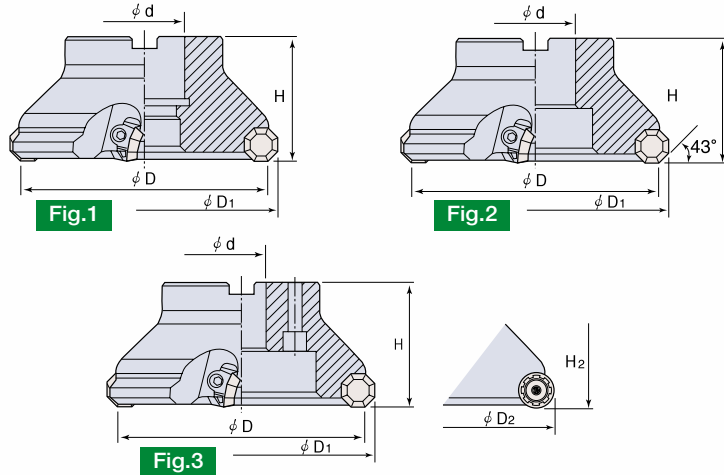

Designation		Dimension (inch)						Weight (lb)	Fig	Mounting Bolt	Wedge	Screw	Wrench
		D	D <sub>1</sub>	D <sub>2</sub>	d	H	H <sub>2</sub>						
TFM43OFW -D2.50R-07	4	2.50	2.93	3.01	.75	1.57	1.59	1.1	1	SH-3-8I	WFOF07R	WS8S	T-W4
-D3.00R-07	5	3.00	3.43	3.51	1.00	1.75	1.77	2.8	1	SH-1-2I		WS8	
-D4.00R-07	6	4.00	4.43	4.51	1.50	2.00	2.02	4.0	2	-			
-D5.00R-07	8	5.00	5.43	5.51	1.50	2.00	2.02	6.6	2	-			
-D6.00R-07	10	6.00	6.43	6.51	2.00	2.00	2.02	10.4	3	-			
-D8.00R-07	12	8.00	8.43	8.51	2.50	2.37	2.39	14.5	3	-			
-D10.00R-07	14	10.00	10.43	10.51	2.50	2.37	2.39	21.9	3	-			

● D<sub>2</sub> & H<sub>2</sub> : Dimensions with Round inserts RFMR19

● New TFM43AOFW cutter will be delivered when the stock of TFM43OFW cutter is depleted. (New TFM43AOFW Wedge: WFZ8-OF)

# ChaseMold

## Features

- General purpose copy & contour milling for Die and Mold
- Large chip gullets for excellent chip removal
- Strong cutting edges for maximum productivity



## Insert

- RDMX □□□□ :  
D5, D7, D10, D12, D16 Metric  
D.50 Inch
- RCKX 43TN-M :



## End mill

### Modular Milling Heads

- TERD-□□-M□□  
with RDMX□□

## Flex-fit System

### Shank for modular milling head

- TM-□□-L□□-□□

## Button Cutter

- TFMRD-□□ -12 with RDMX□□
- TFMRC-□□ -43-F with RCKX43



# ChaseBall-Roughing

## Features

- General purpose copy milling for Die and Mold
- Trigon, radius insert, provides strength while free cutting
- Large chip gullets for maximum metal removal



# ChaseBall-Finishing

## Features

- Best for precision machining of Die & Mold
- Specially designed "S" cutting edges provide excellent performance
- Optimized design for improved cutting edge strength
- PVD coating on ultra fine carbide substrate produces maximum toughness and wear resistance



TaeguTmill - Chase Milling Family